



Walkabout Mother Bins
PO Box 111
600 Main Street
Faulkton, SD 57438

Email: stephanie@motherbin.com
Phone or WhatsApp:
+1 (605) 460-4699



Walkabout® MOTHER BIN 165t Big Red

Designed to help farmers with high capacity combines harvest more acres per day. The extra 50t of storage, over the WMB 110t Eastern Grey, allows combines to keep running long after the elevator closes.

- 165t capacity
- AGRI-COVER® Solar Operable Electric Roll Tarp
- Split front and rear flow gates to blend grain
- 22" unload auger
- 4-way auger spout
- Up to 24t per minute unload rate
- Camera system
- Remote unload
- Self-steering front and force steering rear axles
- Downforce hitch
- Rear access door
- Movable while in field, when partially loaded
- Full length clean out doors
- Minimum 300hp
- 21.61m long x 4.5m wide x 4.00m high

BREAK THE HARVEST BOTTLENECK

The WMB reduces grain cart cycle times. It can be easily moved, even when partially loaded, keeping it in close proximity to the combines.

The WMB allows farmers to operate with less help and less equipment by holding 6 to 8 semi loads of grain.

The WMB reduces soil compaction by enabling you to use smaller grain carts and tractors, reducing weights being carried across the field.

The WMB guarantees the ability to continue or extend harvesting time if: elevators close, the distance from farm or elevator is too far for trucks to keep grain away from combines, problems arise because of slow unloading at the elevator or on-farm storage, breakdowns anywhere in the transport, delivery or storage chain.

DIMENSIONS

WMB 165t Big Red

Overall width:	4.5m
Overall length:	21.61m
Height of top side of bin:	4.00m
Height of low side of bin:	3.49m
Auger height to bottom of spout:	4.81m
Maximum height for transport:	4.20m
Axle width to outside of tires	3.55m
Tire size	VF 445/65R 22.5

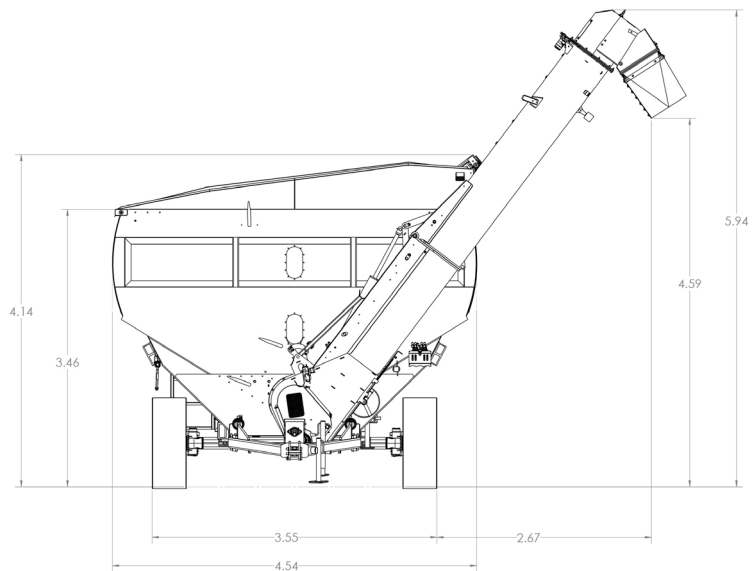

THE SWISS ARMY KNIFE OF EQUIPMENT

As efficiency becomes more and more important in operations, the Mother Bin really is a Swiss army knife piece of equipment that can be used several times during the year to help solve many bottleneck and labour issues.

EMPTY OR FILL GRAIN BAGS

Along with the combine(s), keeping the bagger moving is essential to efficiency. By placing the Mother Bin next to the bagger while filling, the grain cart is never delayed in returning to the combine(s). When emptying, the Mother Bin can move with the bagger so it never has to stop.

USE AS A SEED TENDER

With its 165t capacity, seed trucks are able to tender out of the bin while being positioned in a central location during planting time.

BLEND GRAIN

With the Walkabout Mother Bin, users are able to blend grain to get the desired moisture content by using the split front and rear flow gate feature.

WEATHER PROTECTION

When inclement weather is approaching, users can get their commodity out of the field and protected.

REDUCE SOIL COMPACTION

The Mother Bin allows users to run smaller grain cart(s) and smaller tractors resulting in less compaction. Less soil compaction leads to higher production and less need for tillage or fertilizer to boost production.

