



Walkabout Mother Bins  
PO Box 111  
600 Main Street  
Faulkton, SD 57438

Email: [sales@motherbin.com](mailto:sales@motherbin.com)  
Phone: 1 605-598-2020

MADE IN THE USA



## Walkabout® MOTHER BIN 4000+ Eastern Grey

Harvesting equipment essential for efficient grain handling



- 4,000+ bushel capacity
- AGRI-COVER® Electric Roll Tarp
- Split front and rear flow gates to blend grain
- 22" Elmer's unload auger
- Rotating auger spout
- Up to 900 bushel-per-minute unload rate
- Camera system
- Remote control
- Self-steering front and force steering rear axles
- Rear access door
- Movable while in field, while partially loaded
- Full length clean out doors
- Minimum 230hp, NON-articulated tractor
- 58'11" long x 13'8" wide x 12'9" high

### BREAK THE HARVEST BOTTLENECK

The WMB reduces grain cart cycle times. It can be easily moved, even when partially loaded, keeping it in close proximity to the combines.

The WMB allows farmers to operate with less help and less equipment by holding 4 to 6 semi loads of grain.

The WMB reduces soil compaction by enabling you to use smaller grain carts and tractors, reducing weights being carried across the field.

The WMB guarantees the ability to continue or extend harvesting time if: elevators close, the distance from farm or elevator is too far for trucks to keep grain away from combines, problems arise because of slow unloading at the elevator or on-farm storage, breakdowns anywhere in the transport, delivery or storage chain.

# DIMENSIONS

Overall width	13' 8"
Overall length	58' 11"
Height of top side of bin	12' 9"
Height of low side of bin	11' 1"
Auger height to bottom of spout	15' 3"
Maximum height for transport	13' 5"
Axle width to outside of tires	11' 8"
Tire size	VF 445/65R 22.5

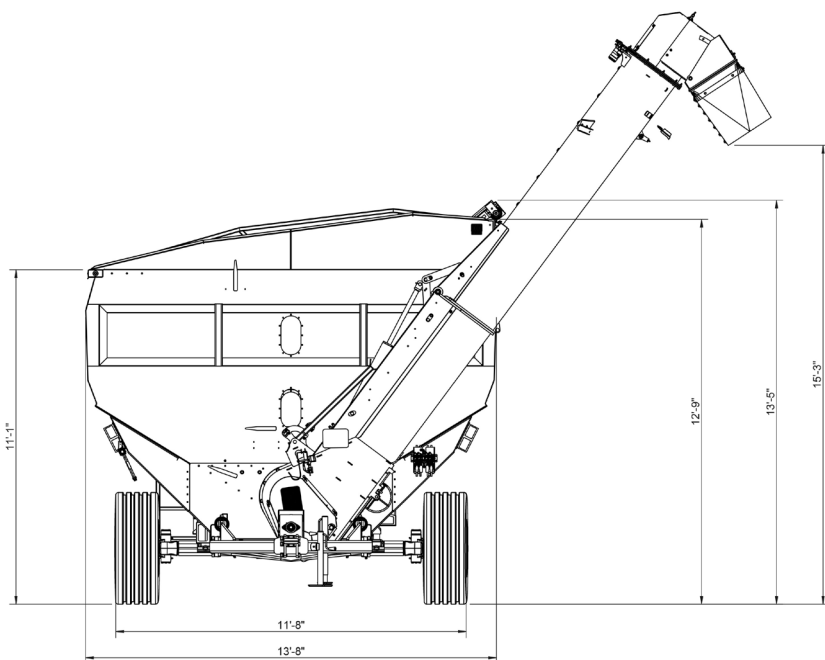

## THE SWISS ARMY KNIFE OF EQUIPMENT

As efficiency becomes more and more important in operations, the Mother Bin really is a Swiss army knife piece of equipment that can be used several times during the year to help solve many bottleneck and labour issues.

### EMPTY OR FILL GRAIN BAGS

Along with the combine(s), keeping the bagger moving is essential to efficiency. By placing the Mother Bin next to the bagger while filling, the grain cart is never delayed in returning to the combine(s). When emptying, the Mother Bin can move with the bagger so it never has to stop.

### USE AS A SEED TENDER

With its 110t capacity, seed trucks are able to tender out of the bin while being positioned in a central location during planting time.

### BLEND GRAIN

With the Walkabout Mother Bin, users are able to blend grain to get the desired moisture content by using the split front and rear flow gate feature.

### WEATHER PROTECTION

When inclement weather is approaching, users can get their commodity out of the field and protected.



Manufactured by MacKow Industries, West Fargo, North Dakota